

## FireStop solution for temporary & permanent service penetrations in both vertical and horizontal applications



Vertical application

### APPLICATIONS

- Metal Pipes
- Cables / Cable trays
- Electrical trunking
- Electrical trunking - for conformance with the 17th Edition of the IEE Wiring Regulations. (BS 7671:2008)

### ADVANTAGES

- Approved as permanent fire barrier
- Reusable
- Dry installation
- Quick and easy installation
- No shelf life
- Moisture resistant

### APPROVALS



Approved CF 5037

ETA 14-0380  
1121-CPR-JA5046

### British Standard

**BS 476 - 20**

**BS EN 1366-3**

**BS EN ISO 10140-3:1995**

The laboratory measurement of airborne sound insulation of building elements

### APPLICATION EXAMPLES:

- Service penetrations like steel pipes, copper pipes, cable bundles, cable trays and electrical trunking through fire rated walls / floors.

### DESCRIPTION

- fischer intumescent pillows - FiP are an intumescent graphite and mineral fibre blend covered in a glass fibre PVC coated cloth bag.
- FiP is suitable for applications where temporary and permanent fire barriers are required.
- Tested to BS 476: Part 20 and BS EN 1366-3, FiP is also ETA approved and CE Marked. FiP can provide up to 2 hours of fire protection in both vertical and horizontal, multi or mixed service penetrations.

### INSTALLATION

**Note: Firestop material must be installed in accordance with detailed instructions or the approved system:**

1. Clean all contact surfaces so they are free from loose debris and contaminants. Ensure services are sufficiently supported as per approved system or local building code.
2. Shake the pillows to make the infill material uniform before installation.
3. Push the pillow into the hole so that the longest dimension spans across the wall. If installing in floor, mechanically fix galvanised steel mesh 50 x 50 x 5mm to the underside of the opening with a 100mm overlap of the floor slab.
4. Pack the pillows in a brick bond fashion, to ensure the joints between the pillows are staggered. Use small size pillows in between to pack the hole tight against the edges.
5. For electrical trunking, remove the lid and install a pillow inside so it aligns with the depth of the wall. Replace the lid on the electrical trunking.

#### Installation in walls

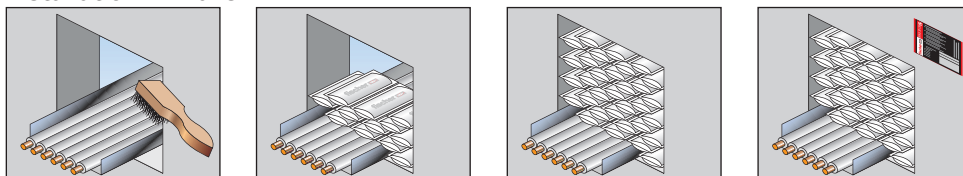

#### Installation in floors

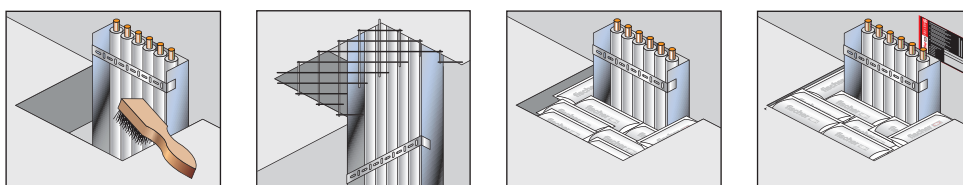

## SPECIFICATIONS

Description	Order No.	Dimensions	Qty. Per Box
<b>FiP / S</b>	516960	330mm x 50mm x 20mm	50
<b>FiP/Std</b>	533890	330mm x 100mm x 20mm	25
<b>FiP / M</b>	516959	330mm x 200mm x 25mm	50
<b>FiP / L</b>	516958	330mm x 200mm x 45mm	25

## TECHNICAL DATA

State	Solid
Colour	Black
Odour	Odourless
Weight per Pillow	FiP/S - 80g, FiP/Std - 120g, FiP/M - 230g, FiP/L - 420g
Volumetric expansion	3 times
Significant expansion occurs at temperature	> 140°C
Remain flexible between	-20°C to 130°C
European Technical Approval	ETA 14-0380
CE Mark	1121-CPR-JA5046

## ESTIMATION QUANTITIES

Width mm	Size → Seal type	Length mm											
		Large	Medium	Large	Medium	Large	Medium	Large	Medium	Large	Medium	Large	Medium
200	Wall	3	5	7	13	12	22	17	31	21	39	24	47
	Floor	2	3	4	7	6	12	9	17	11	22	12	27
400	Wall	5	9	14	26	24	44	33	61	42	78	47	95
	Floor	3	5	7	15	12	24	17	34	22	43	24	52
600	Wall	7	13	21	39	35	65	49	91	63	117	70	143
	Floor	4	7	11	22	18	36	25	51	33	65	36	79
800	Wall	9	18	28	52	47	87	66	122	84	157	94	192
	Floor	5	10	15	29	24	48	34	67	33	87	48	107
1000	Wall	10	22	35	65	59	109	82	152	105	196	117	217
	Floor	6	12	18	36	30	60	42	84	54	108	60	120

## ADDITIONAL INFORMATION

Note: Please refer to MSDS for further information

### Recommendations

1. Can be used as temporary or permanent seal
2. Confirms to requirement of BS 7671 - Section: 527-02-02
3. Can help to maintain sound reduction index of partition

### Storage

1. Store in dry area above the ground
2. Store away from heat sources